

# Subhoshree

(NEAR GORKHARA)

At Sonarpur, 178 Gorkhara



**Developed By:**

## Subho Construction

Office: At 182, R N C Road Subhasgram  
Kolkata- 700147

**Contact:**

9804101234

9836865678

9903013286

e-mail: [subhaconstruction2006@gmail.com](mailto:subhaconstruction2006@gmail.com)



## GROUND FLOOR PLAN



# Subhoshree

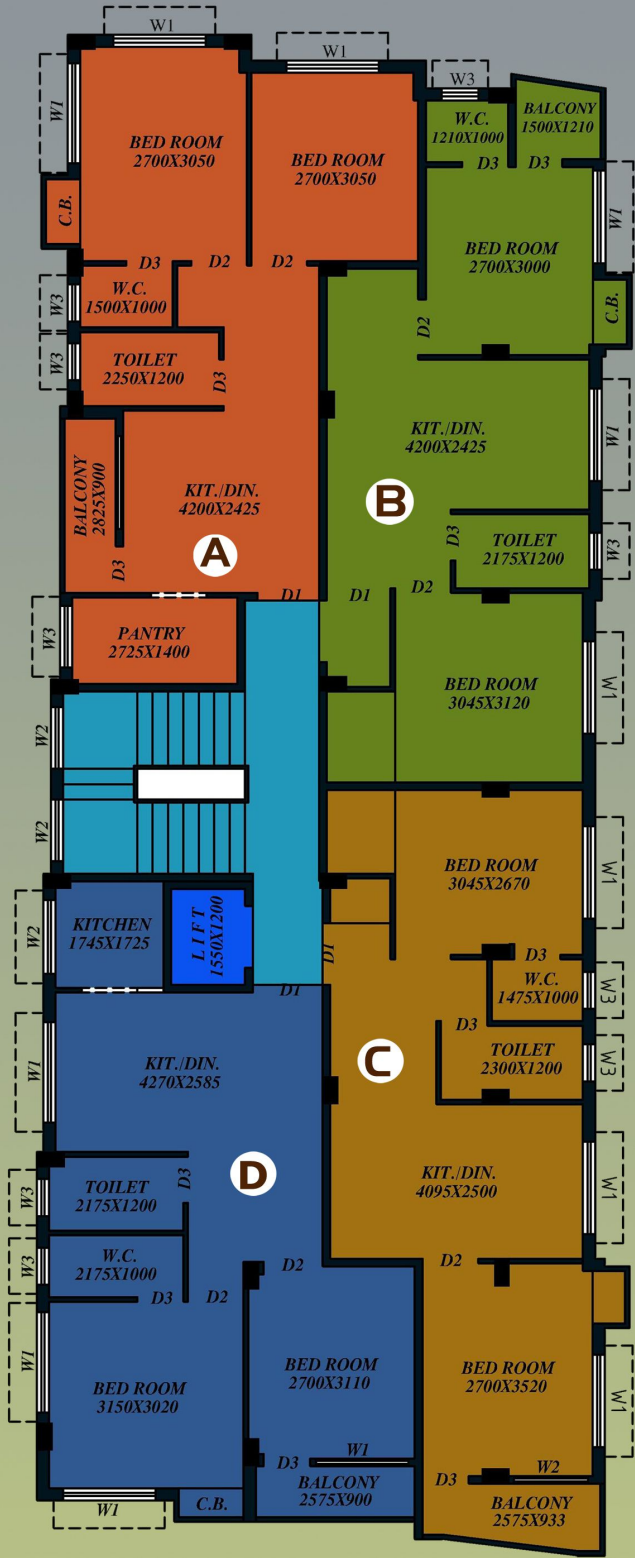

FLAT	SUPER BUILT-UP AREA
A	750 Sq.ft.
B	740 Sq.ft.
C	755 Sq.ft.
D	770 Sq.ft.

Typical Floor Plan



# Specifications

**Flooring :-** Vitrified floor tiles in all units. Antiskid tiles in common areas like staircase, lobby. Paving tiles/ concrete floor in public area etc. Floor tiles in floor & glazed tiles in walls within the toilets.

**Wall:-** Wall putty on all internal walls. Weather coat in outside walls. Glazed tiles on walls and Green slab in kitchen counter top.

**Door:-** Main entrance door: Decorative Flash panel door. Others shall be commercial flush door.

**Windows:-** Aluminum sliding windows with grills.

**Plumbing:-** Concealed GI/ GPVC pipe work in all toilets/ Kitchens. All C.P. fittings of reputed brand.

**Sanitary:-** Good quality sanitary ware in all toilets. Stainless steel sink in kitchens.

**Electrical:-** Multistrand concealed copper wiring of ISI marks.

Switches of reputed brand. ELCB/ MCB for safe electrical distribution system as per the norms. Provision for AC point 1 pc. In every flat cable TV outlet in every flat. Fan & light fittings as per owner's choice at extra cost.

**Other:-** One loft over the toilet and CCTV, LIFT, Power back up & 24 hours water.  
**Facilities**

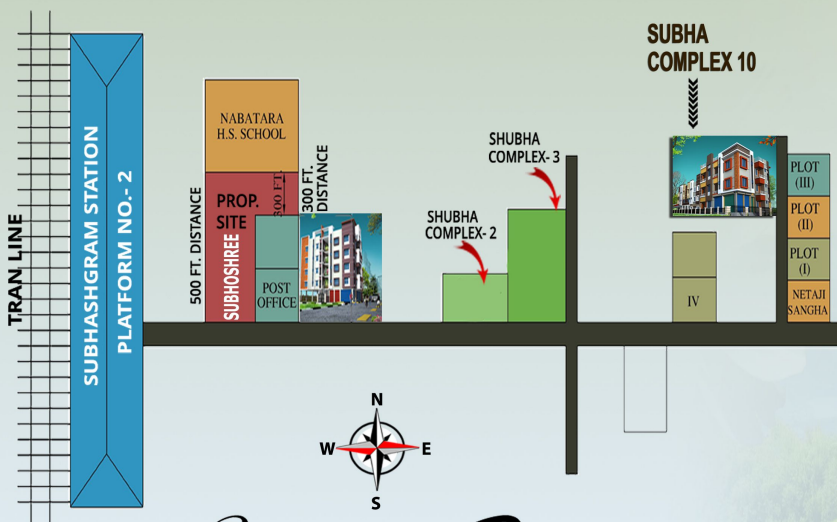

*Location Plan*

**Developed By:**

**Subho Construction**

**Office: At 182, R N C Road Subhasgram  
Kolkata- 700147**

**e-mail: subhoconstruction2006@gmail.com**

**Contact:**

**9804101234**

**9836865678**

**9903013286**

**\*\*The specified brands are provided to give an idea of the quality level we provide in similar current projects. In case of unavailability materials of a brand or any other circumstances, the developer is not legally liable to provide the same brand and may instead substitute material from a brand of similar quality level.**

**This leaflet is not a legal document. The images are imaginary and the details mentioned in this leaflet are tentative and are subject to change at the sole discretion of the developer or Architects.**